

KF Hale Series 2200 Butterfly Valves



page 1 of 2

- Installation,
- Operation, And
- Maintenance

? G U I D E



Installation

Install valve in piping system, noting proper flow direction as indicated on valve body. Use proper size threaded end connections. ▲

Operation

KF Hale Series 2200 Butterfly Valves are recommended for on-off service only. Throttling may cause excessive and non-uniform wear on the disc seal. All KF Butterfly Valves open by rotating handle in counter-clockwise direction. ▲

Maintenance

KF Hale Series 2200 Butterfly Valves are permanently lubricated during assembly and require no routine maintenance.

To remove disc and disc seal: Start with disc (3) in closed position. Remove spring pin (14) and handle assembly (9, 10, 11, 12, and 15) taking care not to lose the ball and spring. Rotate disc 180° and remove disc screws (6) or nuts (8). Remove disc seal (4) from disc. Inspect disc and disc seal for wear. Replace if necessary.

To remove stem and stem seals: With disc removed, pull stem (2) out of body (1). Remove stem seals (5) from stem. Inspect stem and stem seals for wear. Replace if necessary. ▲▶

Reassembly

To replace stem and stem seals: Clean stem and stem hole in body thoroughly, using fine emery if necessary. Replace stem seals on stem. Apply a coat of grease to stem, stem seals, and stem hole. Insert stem into body.

To replace disc and disc seals: Clean disc and interior of body thoroughly, using fine emery if necessary. Apply a coat of grease to disc seal. Lay disc flat with small end up. Place disc seal in groove on disc halfway around the disc. Pull disc seal over remaining edge of disc without twisting. Holding disc securely, compress disc seal into groove at one point with a round smooth object such as a hammer handle. Repeat process completely around disc at one-inch intervals. The disc will then appear like a notched gear. Compress disc seal into groove at all intermediate points. Always move around disc in same direction. Otherwise the disc seal will stretch and there will be a bulge left in the disc seal. Install disc on large side of body seat. Insert screws or studs/nuts and tighten just enough to securely hold disc but not so tight that disc will not center itself in seating area. Rotate disc 180° to fully closed position and tighten screws. Install handle and spring pin, ensuring that ball engages the notches in body. ▲▶

Engineering Solutions for the World's Flow Control Industry

1500 S.E. 89th Street
Oklahoma City, OK 73143-5249
<http://www.kfvalves.com>



KF Industries

A Division of CIRCOR International, Inc.

Tel: 405 631-1533
Fax: 405 631-5034
Email: kfinfo@kfvalves.com

©2000 KF Industries, Inc. • KF2200IOMr3/00 • KF reserves the right to change designs, materials or specifications without notice or without obligation to furnish or install such changes on products previously or subsequently sold. KF Industries is a division of CIRCOR International, Inc.

KF Hale Series 2200 Butterfly Valves



Component Parts

? G U I D E

Parts List

No.	Description
1	Body
2	Stem
3	Disc
4	Disc Seal
5	Stem Seal*
6	Screw or Stud**
7	Lockwasher***
8	Disc Nut**
9	Handle Hub
10	Ball
11	Spring
12	Handle Stub
13	Lock Nut
14	Pin
15	Handle Extension
16	Name Plate
18	Disc/Stem Seal****

* 1 1/2", 2 1/2" & 6" have additional stem seal at bottom.

** 2 1/2" & 6" use studs and nuts

*** 2", 2 1/2" & 6" only

**** 1 1/2", 3" and 4" only

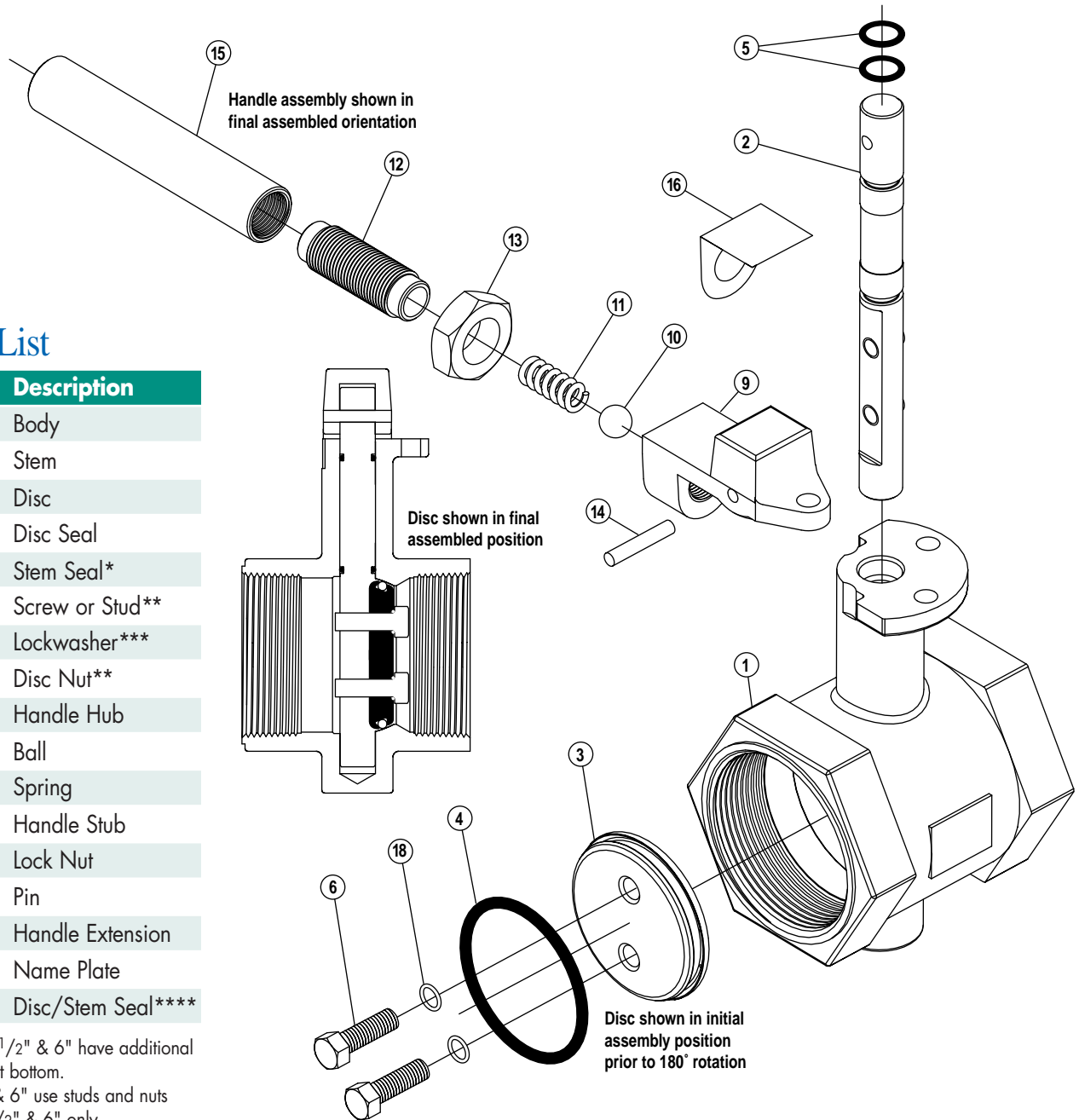

▲ Return to top

Engineering Solutions for the World's Flow Control Industry

1500 S.E. 89th Street
 Oklahoma City, OK 73143-5249
<http://www.kfvalves.com>



KF Industries
 A Division of CIRCOR International, Inc.

Tel: 405 631-1533
 Fax: 405 631-5034
 Email: kfinfo@kfvalves.com